

BILL OF MATERIAL INSTRUCTIONS

In this phase of the competition you will have to look at Sheets 2 and 3.
 You will have to calculate some dimensions while others are given.
 ALL DIMENSIONS HAVE A $\pm \frac{1}{32}$ " TOLERANCE

CONTESTANT # _____

BILL OF MATERIALS

#	QTY	DESCRIPTION	MATERIAL	THICKNESS	WIDTH	LENGTH	NOTES
1	1	SHELF	Solid Stock	$\frac{3}{4}$ "	5 $\frac{1}{2}$ "		Use screws and wood glue to attach shelf rack pieces
2	1	BACK	Solid Stock	$\frac{3}{4}$ "	5 $\frac{1}{2}$ "		Use screws and wood glue to attach shelf rack pieces
3	2	SUPPORTS	Solid Stock	$\frac{3}{4}$ "	3 $\frac{3}{4}$ "		Use screws and wood glue to attach shelf rack pieces

MATERIAL LAYOUT INSTRUCTIONS

Once you've completed your Bill of Materials, lay out your parts on the corresponding material by drawing lines vertically and horizontally.

Note: Each square is scaled to a 1" square.

PART 1

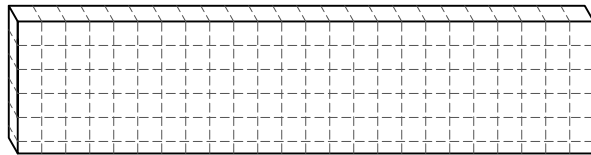

PART 2

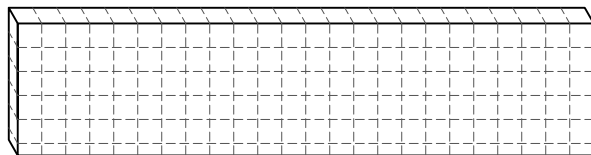

-YOU WILL RECEIVE TWO PIECES OF
 SOLID STOCK FOR THE SHELF AND BACK
 2 @ $\frac{3}{4}$ " x 5- $\frac{1}{2}$ " x 24"±



-YOU WILL RECEIVE THREE COAT
 HOOKS (3)
 3 @ 2- $\frac{1}{4}$ " x 1- $\frac{1}{4}$ " x 3"

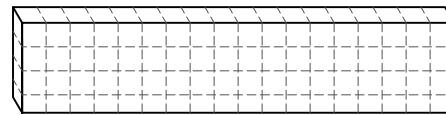

PART 3

-YOU WILL RECEIVE ONE PIECE OF
 SOLID STOCK FOR THE SUPPORTS (2)
 1 @ $\frac{3}{4}$ " x 3- $\frac{3}{4}$ " x 18"±

NOTES:

CONTESTANT # _____

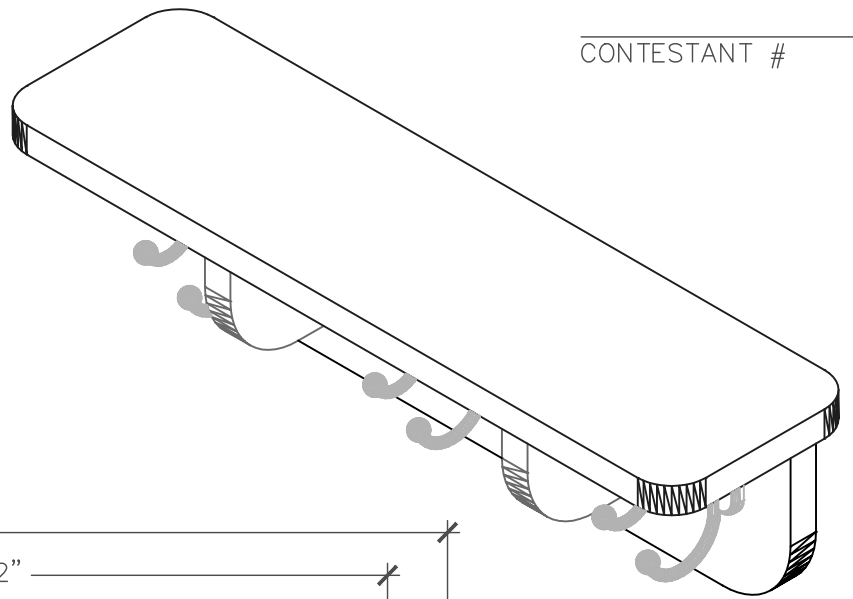

ISOMETRIC

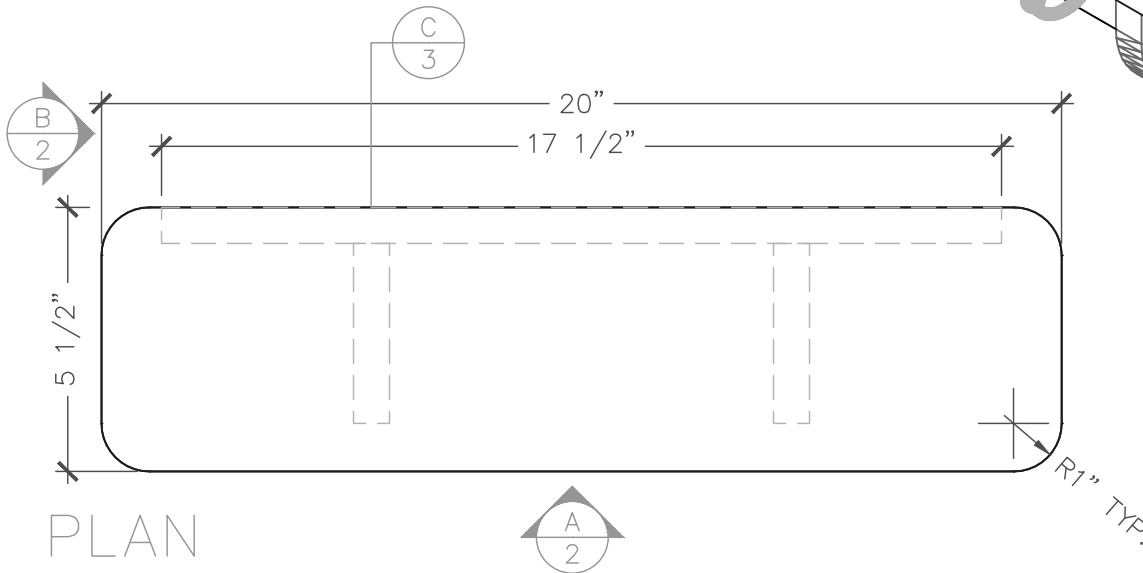

PLAN

SCALE: 3"=1'-0"

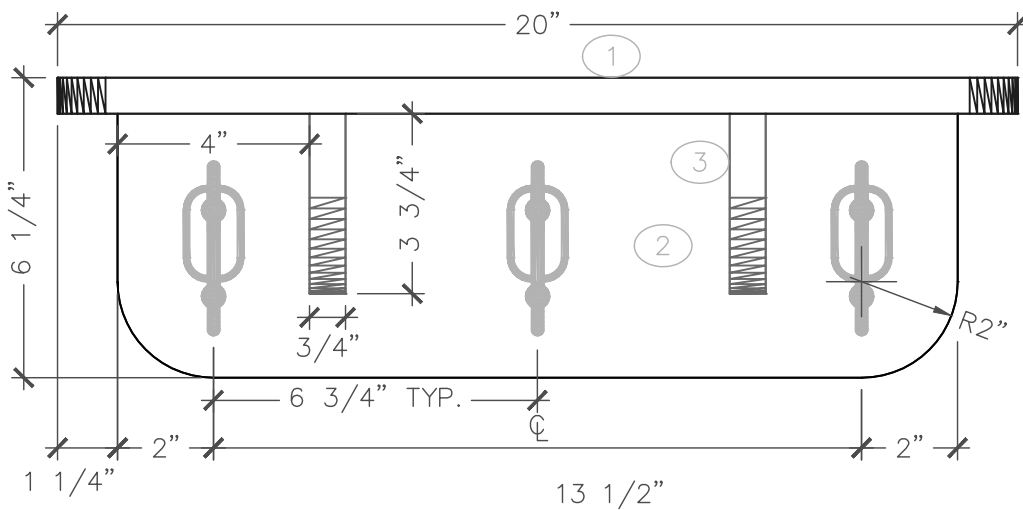

A ELEVATION
SCALE: 3"=1'-0"

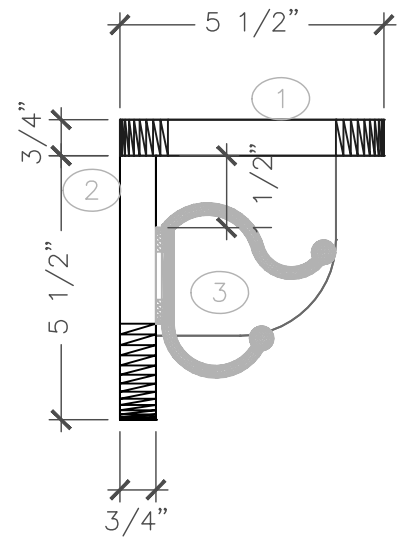

B ELEVATION
SCALE: 3"=1'-0"

SkillsUSA
CALIFORNIA
REGIONAL CONTEST

INTRO WOODWORKING
SHELF RACK
DETAILS

DATE: 2020	JOB #: IW
DRAWN BY: AK	SCALE: NTS
DWG. NO. 2	

CONTESTANT # _____

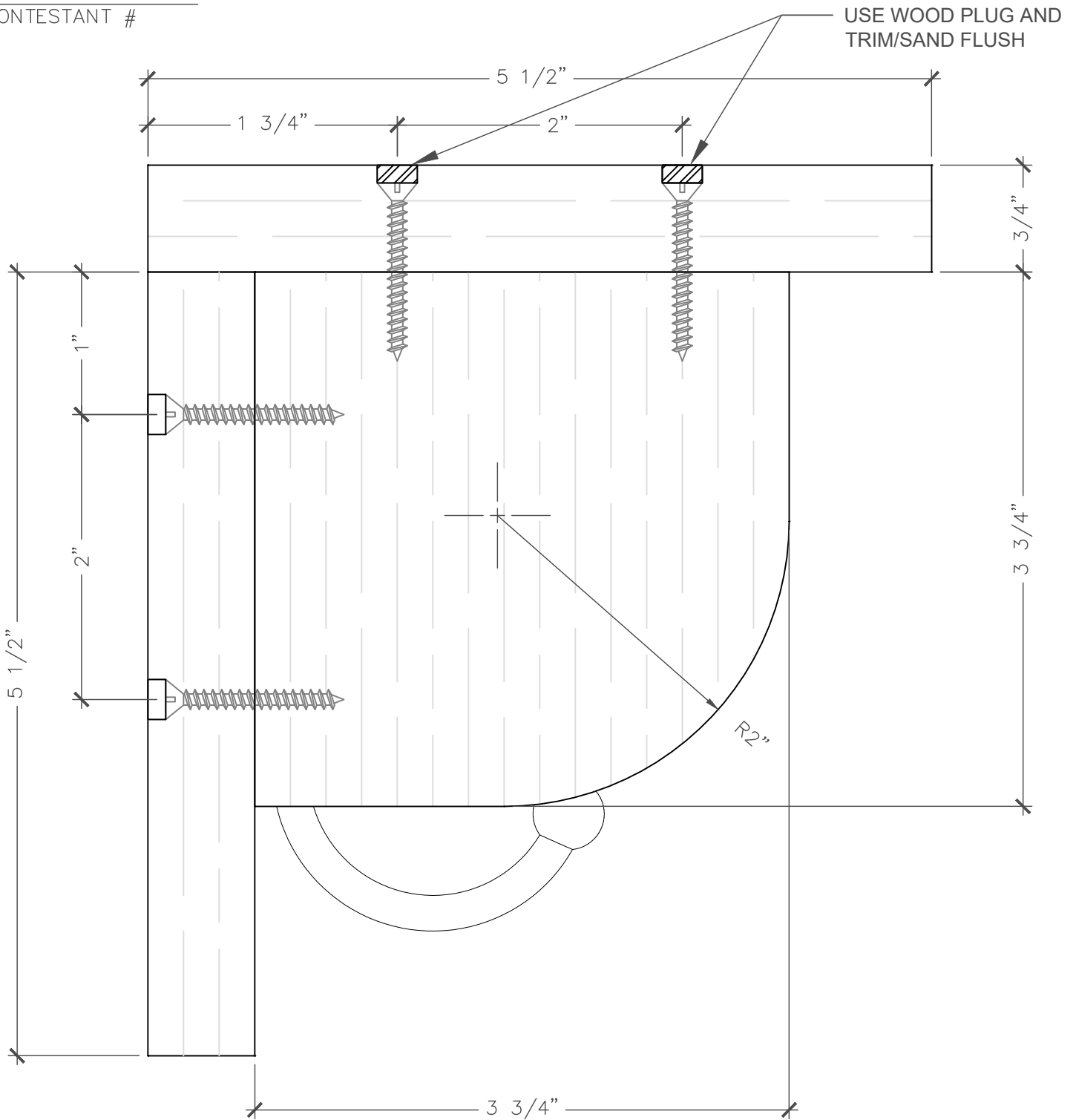

C

VERT SECTION

SCALE: FULL

SkillsUSA
CALIFORNIA
REGIONAL CONTEST

INTRO WOODWORKING
SHELF RACK
VERTICAL SECTION

DATE:	2020	JOB #:	IW
DRAWN BY:	AK	SCALE:	NTS
DWG. NO.	3		

SkillsUSA 2020 Regional Intro to Wood Material 20 Contestants

#2 Common - $\frac{3}{4}$ " PINE - 16'

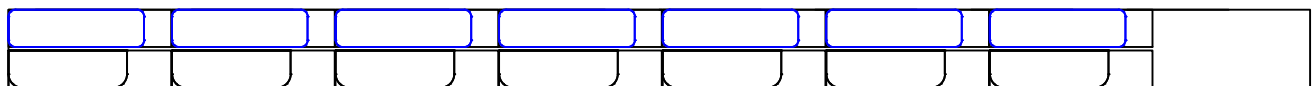
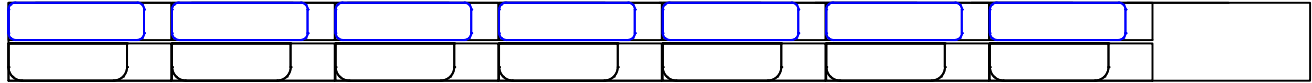
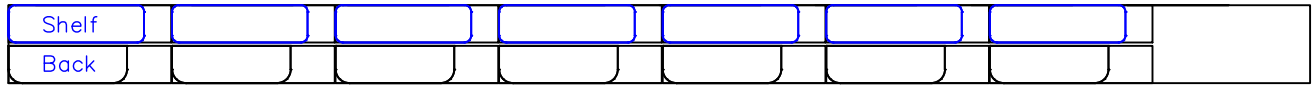

Supports

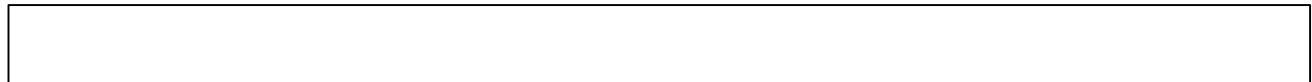
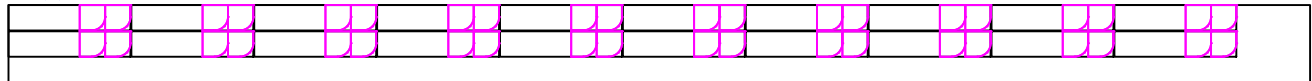

Solid Stock
6+ Planks #2 Common Pine -
 $\frac{3}{4}$ " X $11\frac{1}{2}$ " X 16'

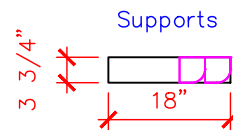
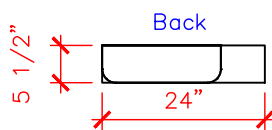
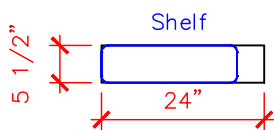

20 PCS EA.

SkillsUSA
CALIFORNIA
REGIONAL CONTEST

INTRO WOODWORKING
CONTEST
MATERIALS

DATE: 2020	JOB #: IW
DRAWN BY: AK	SCALE: NTS
DWG. NO. COORD	

BILL OF MATERIAL INSTRUCTIONS

In this phase of the competition you will have to look at Sheets 2 and 3.
 You will have to calculate some dimensions while others are given.
 ALL DIMENSIONS HAVE A $\pm \frac{1}{32}$ " TOLERANCE

BILL OF MATERIALS

#	QTY	DESCRIPTION	MATERIAL	THICKNESS	WIDTH	LENGTH	NOTES
1	1	SHELF	Solid Stock	$\frac{3}{4}$ "	$5 \frac{1}{2}$ "	20"	Use screws and wood glue to attach shelf rack pieces
2	1	BACK	Solid Stock	$\frac{3}{4}$ "	$5 \frac{1}{2}$ "	$17 \frac{1}{2}$ "	Use screws and wood glue to attach shelf rack pieces
3	2	SUPPORTS	Solid Stock	$\frac{3}{4}$ "	$3 \frac{3}{4}$ "	$3 \frac{3}{4}$ "	Use screws and wood glue to attach shelf rack pieces

MATERIAL LAYOUT INSTRUCTIONS

Once you've completed your Bill of Materials, lay out your parts on the corresponding material by drawing lines vertically and horizontally.

Note: Each square is scaled to a 1" square.

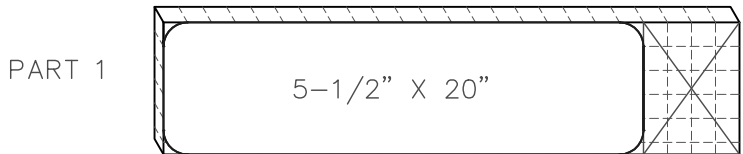

-YOU WILL RECEIVE THREE COAT HOOKS (3)
 3 @ 2-1/4" x 1-1/4" x 3"

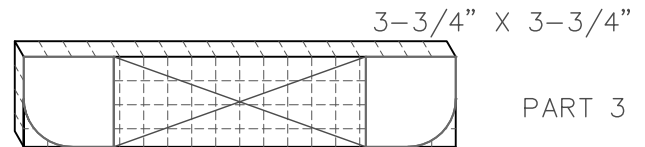
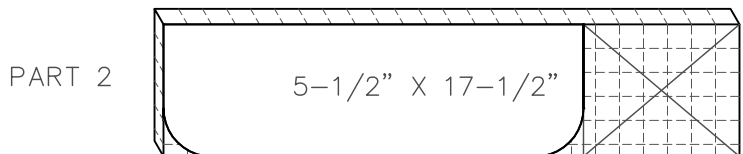

-YOU WILL RECEIVE TWO PIECES OF SOLID STOCK FOR THE SHELF AND BACK
 2 @ $\frac{3}{4}$ " x $5 \frac{1}{2}$ " x $24 \pm$

-YOU WILL RECEIVE ONE PIECE OF SOLID STOCK FOR THE SUPPORTS (2)
 1 @ $\frac{3}{4}$ " x $3 \frac{3}{4}$ " x $18 \pm$

NOTES:

KEY

SkillsUSA
 CALIFORNIA
 REGIONAL CONTEST

INTRO WOODWORKING
 BILL OF MATERIALS
 AND LAYOUT KEY

DATE: 2020	JOB #: IW
DRAWN BY: AK	SCALE: NTS
DWG. NO. 1 KEY	